

## SCHWINGMETALL Elemente

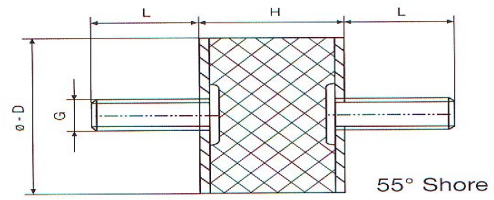

**Gummi - Metall - Puffer**



**Ausführung A**

D	H	G	L	T
08	08	M 3	06	
10	10	M 4	10	
10	15	M 4	10	
15	07	M 4	10	
15	08	M 4	10	
15	10	M 4	10	
15	15	M 4	10	
15	25	M 4	10	
20	08	M 6	18	
20	10	M 6	18	
20	15	M 6	18	
20	20	M 6	18	
20	25	M 6	18	
25	10	M 6	18	
25	15	M 6	18	
25	20	M 6	18	
25	25	M 6	18	
25	30	M 6	18	
25	15	M 8	20	
25	20	M 8	20	
25	25	M 8	20	
25	30	M 8	20	
30	15	M 8	20	
30	20	M 8	20	
30	25	M 8	20	
30	30	M 8	20	
30	34	M 8	20	
30	35	M 8	20	
30	40	M 8	20	
30	42	M 8	20	
40	20	M 8	20	
40	25	M 8	20	
40	30	M 8	20	
40	35	M 8	20	
40	40	M 8	20	
40	25	M 10	28	
40	30	M 10	28	
40	40	M 10	28	

## Gummi - Metall - Puffer

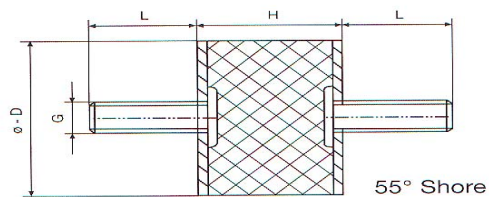

### Ausführung A

D	H	G	L	T
50	20	M 10	28	
50	25	M 10	28	
50	30	M 10	28	
50	40	M 10	28	
50	45	M 10	28	
50	50	M 10	28	
60	20	M 10	28	
60	30	M 10	28	
60	40	M 10	28	
70	25	M 10	28	
70	30	M 10	28	
70	45	M 10	28	
70	60	M 10	28	
70	60	M 12	37	
75	25	M 12	37	
75	40	M 12	37	
75	50	M 12	37	
75	55	M 12	37	
75	50	M 16	42	
75	55	M 16	42	
100	40	M 16	41	
100	50	M 16	41	
100	55	M 16	41	
100	60	M 16	41	
100	75	M 16	41	
100	100	M 16	41	
125	75	M 16	41	
125	100	M 16	41	
150	50	M 16	40	
150	55	M 16	40	
150	75	M 16	40	
150	50	M 20	45	
150	55	M 20	45	
150	75	M 20	45	
200	100	M 20	45	

**Gummi - Metall - Puffer**

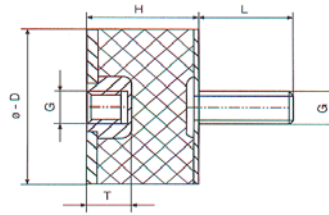

**Ausführung B**

D	H	G	L	T
08	08	M 3	06	3
10	10	M 4	10	5
10	15	M 4	10	5
15	15	M 4	10	5
15	25	M 4	10	5
20	15	M 6	16	6
20	20	M 6	16	6
20	25	M 6	16	6
25	15	M 6	18	6
25	20	M 6	18	6
25	25	M 6	18	6
25	30	M 6	18	6
25	20	M 8	20	7
25	25	M 8	20	7
25	30	M 8	20	7
30	15	M 8	20	8
30	20	M 8	20	8
30	25	M 8	20	8
30	30	M 8	20	8
30	34	M 8	20	8
30	35	M 8	20	8
30	40	M 8	20	8
30	42	M 8	20	8
40	20	M 8	23	8
40	25	M 8	23	8
40	30	M 8	23	8
40	40	M 8	23	8
40	25	M 10	28	10
40	30	M 10	28	10
40	40	M 10	28	10
50	20	M 10	28	10
50	25	M 10	28	10
50	30	M 10	28	10
50	40	M 10	28	10
50	45	M 10	28	10
50	50	M 10	28	10
60	20	M 10	28	10
60	30	M 10	28	10

**Gummi - Metall - Puffer**

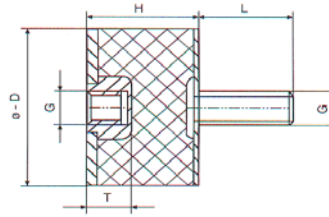

**Ausführung B**

D	H	G	L	T
70	30	M 10	28	10
70	45	M 10	28	10
70	60	M 10	28	10
70	60	M 12	37	12
75	40	M 12	37	12
75	50	M 12	37	12
75	55	M 12	37	12
75	50	M 16	42	16
75	55	M 16	42	16
100	40	M 16	41	16
100	50	M 16	41	16
100	55	M 16	41	16
100	60	M 16	41	16
100	75	M 16	41	16
100	100	M 16	41	16
125	75	M 16	41	16
125	100	M 16	41	16
150	50	M 16	40	16
150	55	M 16	40	16
150	75	M 16	40	16
150	50	M 20	45	20
150	55	M 20	45	20
150	75	M 20	45	20
200	100	M 20	45	20

Gummi - Metall - Puffer

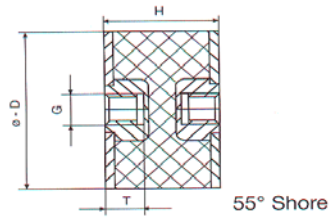

Ausführung C

D	H	G	L	T
10	15	M 4		5
15	15	M 4		5
15	25	M 4		5
20	20	M 6		6
20	25	M 6		6
25	20	M 6		6
25	25	M 6		6
25	30	M 6		6
25	25	M 8		7
25	30	M 8		7
30	20	M 8		8
30	25	M 8		8
30	30	M 8		8
30	34	M 8		8
30	35	M 8		8
30	40	M 8		8
30	42	M 8		8
40	30	M 8		8
40	35	M 8		8
40	40	M 8		8
40	30	M 10		10
40	35	M 10		10
40	40	M 10		10
50	30	M 10		10
50	40	M 10		10
50	45	M 10		10
50	50	M 10		10
60	30	M 10		10
60	40	M 10		10
70	45	M 10		10
70	60	M 10		10
70	60	M 12		12
75	40	M 12		12
75	50	M 12		12
75	55	M 12		12
75	50	M 16		16
75	55	M 16		16

Gummi - Metall - Puffer

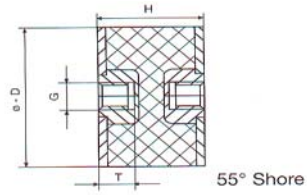

Ausführung C

D	H	G	L	T
100	40	M 16		16
100	50	M 16		16
100	55	M 16		16
100	60	M 16		16
100	75	M 16		16
100	100	M 16		16
125	75	M 16		16
125	100	M 16		16
150	50	M 16		16
150	55	M 16		16
150	75	M 16		16
150	50	M 20		20
150	55	M 20		20
150	75	M 20		20
200	100	M 20		20

Gummi - Metall - Puffer

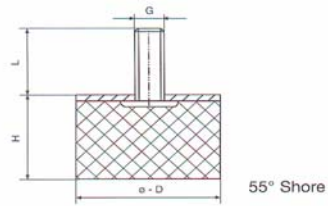

Ausführung D

D	H	G	L	
08	08	M 3	06	
10	10	M 4	10	
10	15	M 4	10	
15	07	M 4	10	
15	08	M 4	10	
15	10	M 4	10	
15	15	M 4	10	
15	25	M 4	10	
20	04	M 6	18	
20	05	M 6	18	
20	08	M 6	18	
20	10	M 6	18	
20	11	M 6	18	
20	13	M 6	18	
20	15	M 6	18	
20	20	M 6	18	
20	25	M 6	18	
25	10	M 6	18	
25	13	M 6	18	
25	15	M 6	18	
25	17	M 6	18	
25	20	M 6	18	
25	25	M 6	18	
25	30	M 6	18	
25	10	M 8	20	
25	15	M 8	20	
25	20	M 8	20	
25	25	M 8	20	
25	30	M 8	20	
30	08	M 8	20	
30	10	M 8	20	
30	15	M 8	20	
30	17	M 8	20	
30	20	M 8	20	
30	25	M 8	20	
30	28	M 8	20	
30	30	M 8	20	
30	34	M 8	20	
30	35	M 8	20	
30	40	M 8	20	
30	42	M 8	20	



Gummi - Metall - Puffer

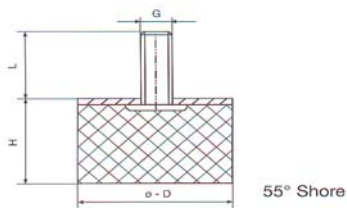

Ausführung D

D	H	G	L	
40	20	M 8	23	
40	25	M 8	23	
40	30	M 8	23	
40	40	M 8	23	
40	20	M 10	28	
40	25	M 10	28	
40	30	M 10	28	
40	40	M 10	28	
50	20	M 10	28	
50	25	M 10	28	
50	30	M 10	28	
50	40	M 10	28	
50	45	M 10	28	
50	50	M 10	28	
60	25	M 10	28	
60	30	M 10	28	
60	40	M 10	28	
70	25	M 10	28	
70	30	M 10	28	
70	45	M 10	28	
70	60	M 10	28	
70	60	M 12	37	
75	25	M 12	37	
75	40	M 12	37	
75	50	M 12	37	
75	55	M 12	37	
75	40	M 16	42	
75	50	M 16	42	
75	55	M 16	42	
100	40	M 16	41	
100	50	M 16	41	
100	55	M 16	41	
100	60	M 16	41	
100	75	M 16	41	
100	100	M 16	41	
125	25	M 16	41	
125	75	M 16	41	
125	100	M 16	41	

**Gummi - Metall - Puffer**

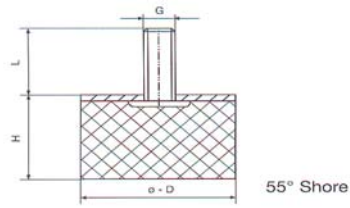

**Ausführung D**

D	H	G	L	
150	50	M 16	40	
150	55	M 16	40	
150	60	M 16	40	
150	75	M 16	40	
150	120	M 16	40	
150	50	M 20	45	
150	55	M 20	45	
150	60	M 20	45	
150	75	M 20	45	
160	45	M 16	40	
160	75	M 16	40	
160	10	M 16	40	
200	100	M 20	45	
250	45	M 16	40	

## Gummi - Metall - Puffer

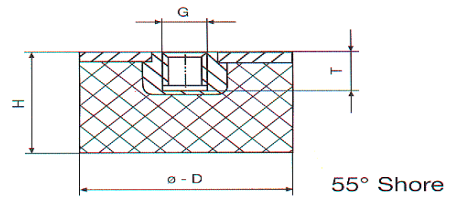

### Ausführung E

D	H	G	L	T
08	08	M 3		3
10	10	M 4		4
10	15	M 4		4
15	08	M 4		5
15	10	M 4		5
15	15	M 4		5
15	25	M 4		5
20	10	M 6		6
20	13	M 6		6
20	15	M 6		6
20	20	M 6		6
20	25	M 6		6
25	10	M 6		6
25	13	M 6		6
25	15	M 6		6
25	17	M 6		6
25	20	M 6		6
25	25	M 6		6
25	30	M 6		6
25	15	M 8		7
25	20	M 8		7
25	25	M 8		7
25	30	M 8		7
30	15	M 8		8
30	17	M 8		8
30	20	M 8		8
30	25	M 8		8
30	28	M 8		8
30	30	M 8		8
30	34	M 8		8
30	35	M 8		8
30	40	M 8		8
30	42	M 8		8
40	20	M 8		8
40	25	M 8		8
40	30	M 8		8
40	40	M 8		8
40	25	M 10		10
40	30	M 10		10
40	40	M 10		10

**Gummi - Metall - Puffer**

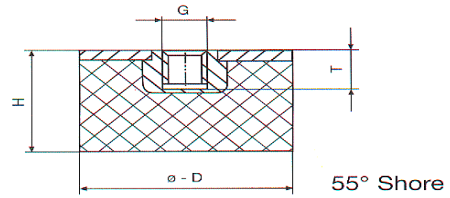

**Ausführung E**

D	H	G	L	T
60	25	M 10		10
60	30	M 10		10
60	45	M 10		10
70	25	M 10		10
70	30	M 10		10
70	45	M 10		10
70	60	M 10		10
70	60	M 12		12
75	25	M 12		12
75	40	M 12		12
75	50	M 12		12
75	55	M 12		12
75	40	M 16		16
75	50	M 16		16
75	55	M 16		16
100	40	M 16		16
100	50	M 16		16
100	55	M 16		16
100	60	M 16		16
100	75	M 16		16
100	100	M 16		16
125	25	M 16		16
125	75	M 16		16
125	100	M 16		16
150	50	M 16		16
150	55	M 16		16
150	60	M 16		16
150	50	M 20		20
150	55	M 20		20
150	60	M 20		20
150	75	M 20		20
160	45	M 16		16
160	75	M 16		16
160	10	M 16		16
200	100	M 20		20
250	45	M 16		16

**GUMMI-METALL-  
Schienen**

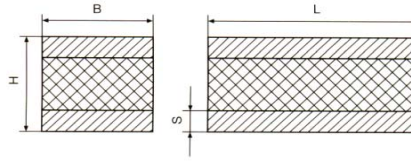

**Ausführung A - Metall beiderseits**

Ausführung	Breite B	Höhe H	Länge L	Metall mm S
A	50	35	300	10
A	50	45	300	10
A	50	55	300	10
A	50	60	300	10
A	50	75	300	10
A	70	30	130	10
A	70	40	130	10
A	70	50	130	10
A	70	55	130	10
A	70	60	130	10
A	70	70	130	10
A	75	30	160	10
A	75	40	160	10
A	75	50	160	10
A	75	55	160	10
A	90	40	290	10
A	90	50	290	10/15
A	90	60	290	10/15
A	90	70	290	10/15
A	90	80	290	10/15
A	100	40	325	10
A	100	45	325	15
A	100	55	325	15
A	100	60	325	15
A	100	40	130	10
A	100	45	130	10/15
A	100	55	130	10/15
A	100	60	130	10/15
A	100	70	130	10/15
A	150	50	300	15
A	150	60	300	15
A	150	80	300	15

**GUMMI-METALL-  
Anschlagschienen**

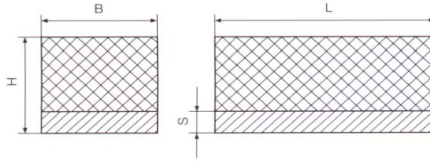

**Ausführung AN - Metall einseitig**

Ausführung	Breite B	Höhe H	Länge L	Metall mm S
AN	50	35	300	10
AN	50	45	300	10
AN	50	55	300	10
AN	50	60	300	10
AN	50	75	300	10
AN	70	30	130	10
AN	70	40	130	10
AN	70	50	130	10
AN	70	55	130	10
AN	70	60	130	10
AN	70	70	130	10
AN	75	30	160	10
AN	75	40	160	10
AN	75	50	160	10
AN	75	55	160	10
AN	90	40	290	10
AN	90	50	290	10/15
AN	90	60	290	10/15
AN	90	70	290	10/15
AN	90	80	290	10/15
AN	100	40	325	10
AN	100	45	325	15
AN	100	55	325	15
AN	100	60	325	15
AN	100	40	130	10
AN	100	45	130	10/15
AN	100	55	130	10/15
AN	100	60	130	10/15
AN	100	70	130	10/15
AN	150	50	300	15
AN	150	60	300	15
AN	150	80	300	15

## GUMMI-METALL- Schienen

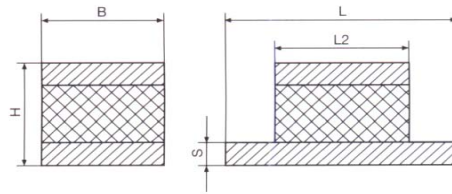

### Ausführung B - Metall einseitig

Ausführung	Breite B	Höhe H	Länge L	Länge 2 L2	Metall mm S
B	70	30	130	60	10
B	70	40	130	60	10
B	70	50	130	60	10
B	70	55	130	60	10
B	70	60	130	60	10
B	70	70	130	60	10
B	75	30	160	90	10
B	75	40	160	90	10
B	75	50	160	90	10
B	75	55	160	90	10
B	90	40	290	220	10
B	90	50	290	220	10/15
B	90	60	290	220	10/15
B	90	70	290	220	10/15
B	90	80	290	220	10/15
B	100	40	325	245	10
B	100	45	325	245	15
B	100	55	325	245	15
B	100	60	325	245	15
B	100	40	130	50	10
B	100	45	130	50	10/15
B	100	55	130	50	10/15
B	100	60	130	50	10/15
B	100	70	130	50	10/15
B	150	50	300	220	15
B	150	60	300	220	15
B	150	80	300	220	15

## GUMMI-METALL- Anschlagschienen

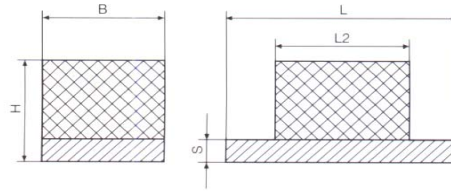

### Ausführung BN - Metall einseitig

Ausführung	Breite B	Höhe H	Länge L	Länge 2 L2	Metall mm S
BN	70	30	130	60	10
BN	70	40	130	60	10
BN	70	50	130	60	10
BN	70	55	130	60	10
BN	70	60	130	60	10
BN	70	70	130	60	10
BN	75	30	160	90	10
BN	75	40	160	90	10
BN	75	50	160	90	10
BN	75	55	160	90	10
BN	90	40	290	220	10
BN	90	50	290	220	10/15
BN	90	60	290	220	10/15
BN	90	70	290	220	10/15
BN	90	80	290	220	10/15
BN	100	40	325	245	10
BN	100	45	325	245	15
BN	100	55	325	245	15
BN	100	60	325	245	15
BN	100	40	130	50	10
BN	100	45	130	50	10/15
BN	100	55	130	50	10/15
BN	100	60	130	50	10/15
BN	100	70	130	50	10/15
BN	150	50	300	220	15
BN	150	60	300	220	15
BN	150	80	300	220	15



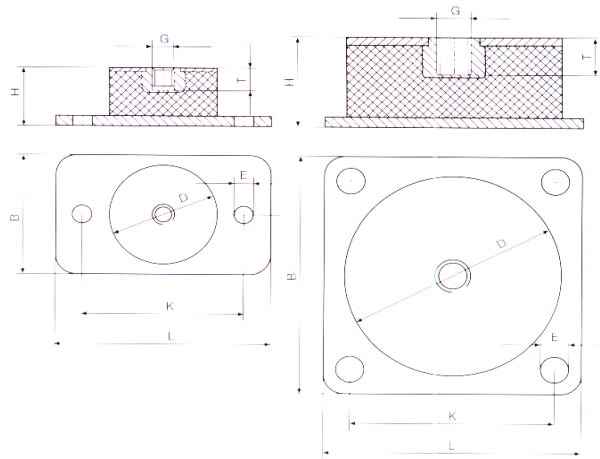

### Ausführung mit Bodenplatte

D	H	L	B	K	E	G
25	33	80	30	60	9	M 6
30	33	80	30	60	9	M 8
50	33	100	60	75	9	M 10
75	45	120	80	105	11	M 12
100	45	130	120	95	13	M 16

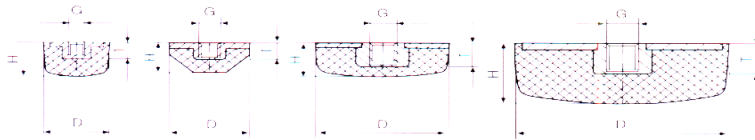
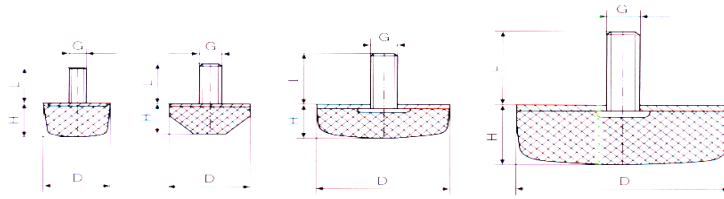

### Ausführung Konische Anschlagpuffer

D	H	G	L	T
25	17	M 6	18	
30	15	M 8	20	
50	17	M 10	28	
80	30	M 12	37	

25	17	M 6		6
30	15	M 8		8
50	17	M 10		10

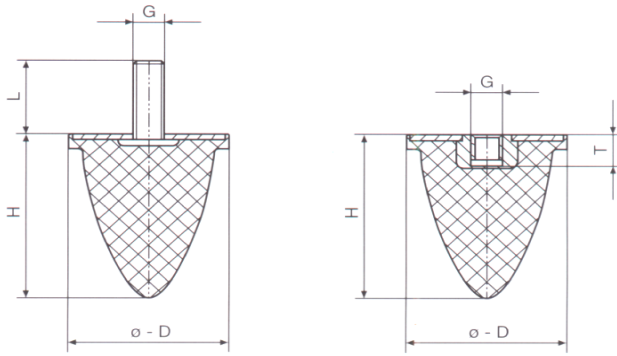

### Ausführung Parabelfeder

D	H	G	L	T
20	24	M 6	18	
30	36	M 8	20	
52	58	M 10	28	
75	89	M 12	37	
115	136	M 16	41	
20	24	M 6		6
30	36	M 8		8
52	58	M 10		10
75	89	M 12		12
115	136	M 16		16